

### Quick installation guide

Full manual is available on [www.satel.eu](http://www.satel.eu)



**The device should be installed by qualified personnel.**

**Before installation, please read the full manual thoroughly.**

**Changes, modifications or repairs not authorized by the manufacturer shall void your rights under the warranty.**

**Disconnect power before making any electrical connections.**

The device should be installed indoors, in spaces with normal air humidity. When choosing the installation location, remember that thick masonry walls, metal partitions etc. reduce the radio signal range. Installing the device in close vicinity of electrical systems is not recommended, since it can affect the range of radio signal.

Run the cables to be used for making connection to the location where the device will be installed. Use an unshielded non-twisted cable. The cabling should not be run in close vicinity of low-voltage electrical system wires, and especially of power cables for high-power equipment (such as electric motors).

1. Loosen the cover locking screws and remove the enclosure cover (Fig. 1).
2. Remove the fixing screws of electronics board and take out the electronics board.
3. Place the enclosure base against the wall and mark location of the mounting holes.
4. Drill holes for wall plugs (anchors) in the wall.
5. Make openings for controller power cables and inputs / outputs cables in the enclosure base.
6. Run the cables through the opening made.
7. Using wall plugs (anchors) and screws, secure the enclosure base to the wall. Use the wall plugs suitable for the specific mounting surface (concrete wall, drywall, etc.).
8. Using screws, install the electronics board in the enclosure.
9. Screw the wires to the terminals on the electronics board.
10. Power on the controller. The device must be supplied from a limited power source.
11. Program the controller (register wireless devices in the controller and configure them).
12. Replace the cover and lock it with screws.

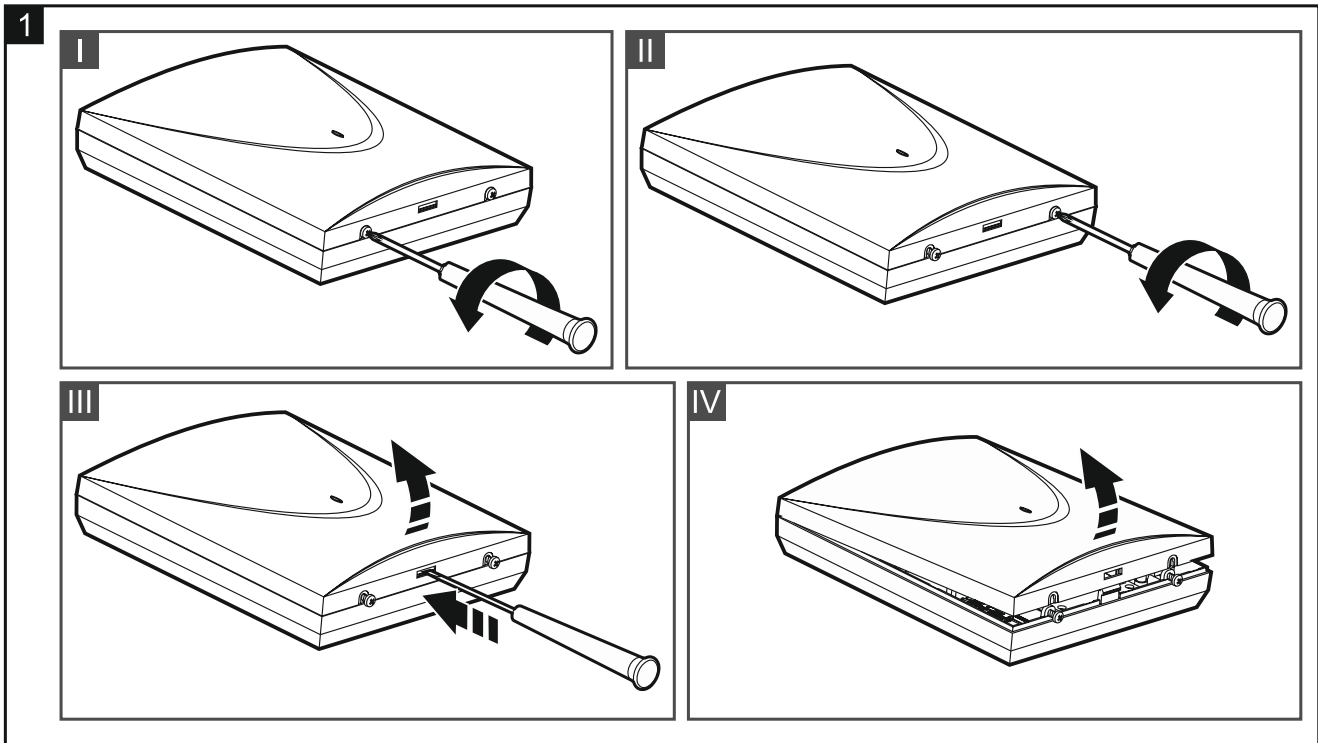

Hereby, SATEL sp. z o.o. declares that the radio equipment type MTX-300 is in compliance with Directive 2014/53/EU. The full text of the EU declaration of conformity is available at the following internet address: [www.satel.eu/ce](http://www.satel.eu/ce)