



HDMI over IP Extender Series

# User Manual

---

Model : HE03L-4K

4K HDMI CAT5e/6 Extender CAT5e 120M/CAT6 140M



## Introduction

HE03L-4K is a 4K HDMI extender that uses a cost-effective Ethernet cable to send an HDMI signal for up to 140M. Its chainable RX allows the extender to split an HDMI signal into up to 250 ones and display the signals at the same time. By pushing the built-in EDID button, you can effortlessly present the video with desire resolution on the monitor.

## Features

- Resolution up to 4K@30Hz 4:4:4.
- Signal extension up to 120M over CAT5e, 140M over CAT6.
- Splits up to 250 HDMI displays, 2.5KM in total.
- Works perfectly with Ethernet repeater (SR01X) to reach longer distances.

## Installation View

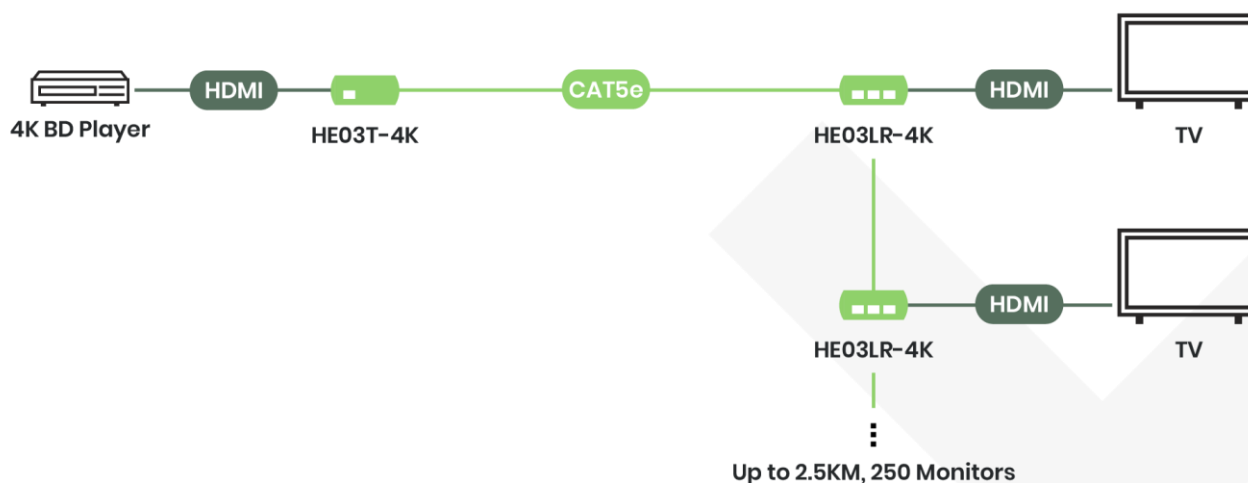

## Panel view

HE03T-4K

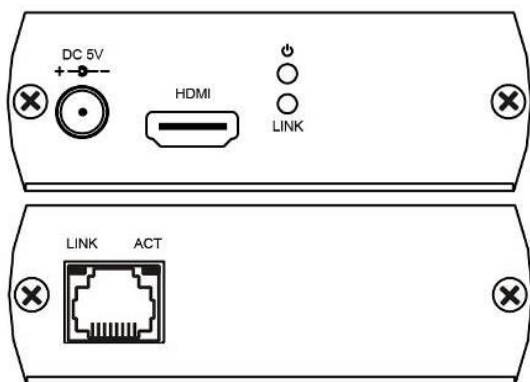

HE03LR-4K

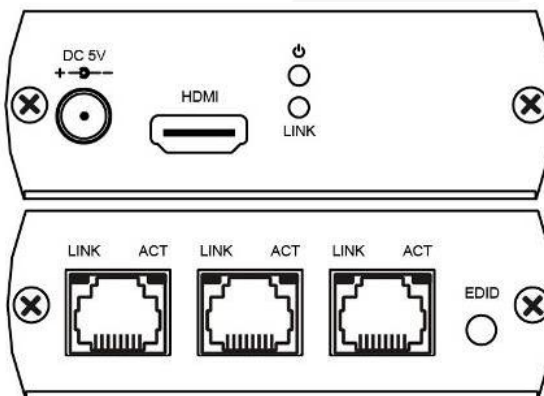

## LED Indication

LED	LED Color	Description
Power	GREEN ON/ OFF	Power on/off
LINK	BLUE ON/ OFF	TX/RX Linked
RJ45	GREEN ON	Linked
RJ45	YELLOW ON	Data Transmission

## EDID Configuration

Button	Description
Press	Display MAC, IP address
Long press for 2 seconds	Copy EDID from receiver to transmitter end.

## RJ45 Pinout

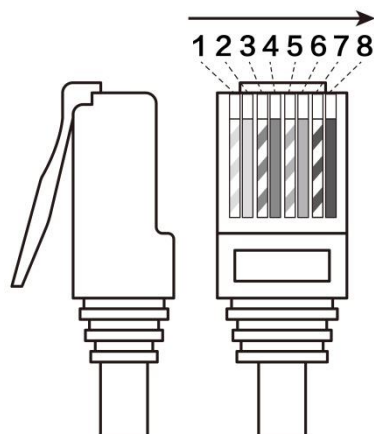

(PIN TIA/EIA-568B)	
PIN	Wire Color
1	Orange-white
2	Orange
3	Green-white
4	Blue
5	Blue-white
6	Green
7	Brown-white
8	Brown

## Caution

- Keep the cables away from any equipment with electromagnetic wave, i.e.: microwave, radio equipment, high voltage.
- Using high quality CAT5e, CAT6 UTP/STP/FTP cable is recommended. Poor quality cable or network connection or improper installation will cause unstable connection, video or sound disruptions, picture noise.
- Transmission data rate up to 850Mbps.
- It is not recommended connect the product to existing LAN structure to avoid crush the network.
- When connect with Gigabit Switch, make sure to turn off EEE (Energy-Efficient Ethernet).

## Package Includes

No.	Item	Quantity
1	HE03T-4K	x 1
2	HE03LR-4K	x 1
3	DC 5V 2A Power Supply	x 2
4	Accessory Set	x 2

## Specification

ITEM NO.	HE03T-4K	HE03LR-4K
Support		
Compliance	HDCP 1.4	
Max. Video Resolution	4K@30Hz 4:4:4, 1920 x 1200@120Hz	
Max. Transmission Distance	120M over CAT5e, 140M over CAT6 cable	
Audio Format	7.1 LPCM 192KHz	
Ports & Interfaces		
Video Input	1 x HDMI Type A	1 x RJ45
Video Output	1 x RJ45	1 x HDMI Type A, 2 x RJ45
Power		
Power Supply	DC 5V 2A	DC 5V 2A
Power Consumption	400mA (Typical), 550mA (Max)	600mA (Typical), 1400mA (Max)
Ambient Temperature		
Operation	0 to 55°C	
Storage	-20 to 85°C	
Humidity	up to 95%	
Physical Characteristics		
Dimensions	88 x 110 x 30mm	88 x 145 x 30mm
Weight	230g	300g